

GENERAL ARRANGEMENT  
1:100 @ A1

KEY

- EXISTING CROSSOVER TO BE TAKEN UP 285mm AND RESURFACED WITH 200MM GRANULAR SUB-BASE TYPE 1 MCHW CLAUSE 803, 60mm AC20 DENSE BINDER COURSE 100/150 TO BS EN 13108-4, 25mm AC6 DENSE SURFACE COURSE 160/220.
- PLANE AND RESURFACE 45mm WITH HRA 5/14 PSV 14.
- 25mm AC6 DENSE SURFACE COURSE 100/150 TO BS EN 13108-4, 50mm AC20 DENSE BINDER 100/150 TO BS EN 13108-4, SUB BASE 150mm TYPE 2
- PROPOSED BELISHA BEACON REFER TO STREET LIGHTING DESIGN FOR SPECIFICATION
- PROPOSED BLISTER TACTILE PAVING 400x400x65mm COLOUR: RED LAID ON 30mm SHARP SAND ON 100mm TYPE 2 SUBBASE MCHW CLAUSE 803. JOINTS BRUSHED WITH KIND DRIED SHARP SAND SURROUNDED BY PRECAST CONCRETE KERBS TYPE EF 255mm
- PROPOSED LEVELS
- PROPOSED 'ACO' HEXDRAIN PRO LOAD CLASS C250 OR SIMILAR APPROVED TO BE LAID IN FRONT AND ALIGNED WITH KERBLINE
- PROPOSED SIGN(S) AS ANNOTATED. SIGN MUST BE SET OUT BY CCC SITE SUPERVISOR OR PROJECT MANAGER ON SITE. SIGN FACE MUST BE AT LEAST 450MM FROM FRONT OF KERB. REFER TO SIGN DETAILS.
- PROPOSED SIGN(S) AS ANNOTATED ON EXISTING POST/LIGHTING COLUMN AS SPECIFIED.
- PROPOSED GLADSTONE MANCHESTER BOLLARD IN DURAPOL WITH LOCKFAST SOCKET AND RED/WHITE MICROPRISMATIC BANDING 2 x 12.5mm & 1 x 63mm.
- PROPOSED PRECAST SILT TRAP TO A DEPTH OF 500MM
- PROPOSED STREET LIGHTING INSPECTION CHAMBER; NAL STAKKABOX 300x450mm
- PROPOSED 50mm ORANGE FLEXIDUCT STAMPED 'STREET LIGHTING' WITH ORANGE DRAW CORDS
- PROPOSED ROAD CROSSING

- TAKE UP OR DOWN AND REMOVE TO TIP ROAD LIGHTING COLUMN. LANTERN TO BE RETURNED TO CARDIFF COUNCIL DEPOT, BRINDLEY ROAD, LECKWITH, CF11 8TX FOR FUTURE USE
- TAKE UP OR DOWN AND REMOVE TO TIP ILLUMINATED SIGN

KERBING KEY

- HB2 PROPOSED PRECAST CONCRETE HALF BATTERED KERB 125x255mm LAID AT 100mm UPSTAND
- BN1 PROPOSED PRECAST CONCRETE BULLNOSED KERB 125x150mm LAID AT 100mm UPSTAND
- BN8 PROPOSED PRECAST CONCRETE BULLNOSED KERB 125x255mm LAID AT 81mm UPSTAND
- BN25 PROPOSED PRECAST CONCRETE BULLNOSED KERB 125x255MM LAID AT 25MM UPSTAND
- TR PROPOSED PRECAST CONCRETE TRANSITION KERB 125x255mm
- TANGENT POINT
- EF PROPOSED PRECAST CONCRETE EDGING KERB TYPE EF 100x50mm

NOTES

- EDGING KERBS TYPE 'EF' 50x150mm LAID AT THE BACK OF FOOTPATH BORDERING ON ALL HOUSE FRONTAGES.
- ALL EXISTING DRAINAGE CHANNEL TO REMAIN. ALL RESURFACING UP TO DRAINAGE CHANNEL
- THE CONTRACTOR IS TO EXPECT APPROXIMATELY 200mm OF HARD DIG IN THE CARRIAGEWAY
- THE CONTRACTOR IS TO EXPECT APPROXIMATELY 75mm OF HARD DIG IN THE FOOTWAY
- DRAWING TO BE READ IN CONJUNCTION WITH LIST OF RELEVANT DRAWINGS

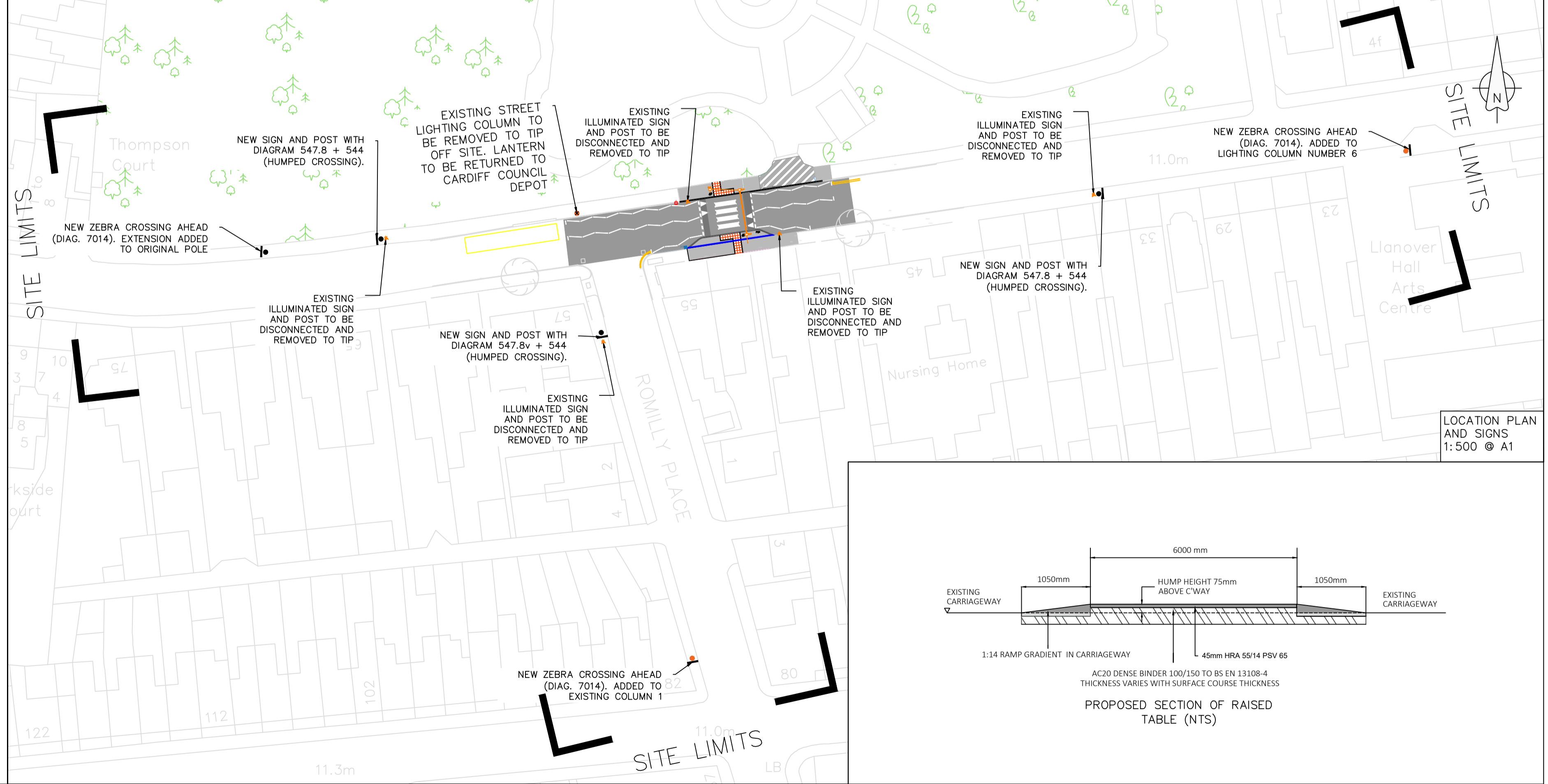

LOCATION PLAN AND SIGNS  
1:500 @ A1

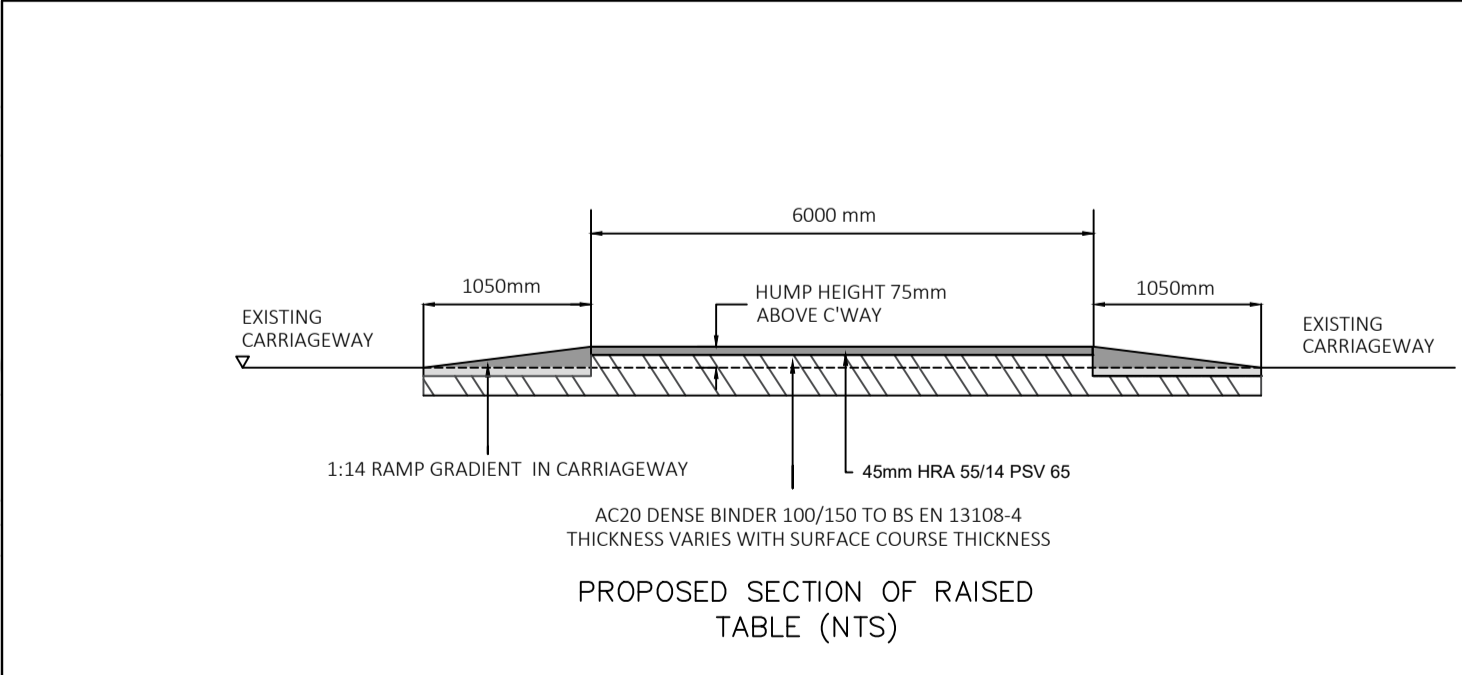

CYNGOR DINAS CAERDYDD THE CITY OF CARDIFF COUNCIL

COPYRIGHT OF CARDIFF COUNCIL. ALL RIGHTS RESERVED.  
DRAWING CAN BE SCALED FOR PLANNING APPLICATION PURPOSES ONLY.

© Crown copyright and database rights (2011) Ordnance Survey 100023376.  
© Hawlfraint y Goron a hawliau cronfa ddata (2011) Arolwg Ordnans 100023376.

**FOR CONSTRUCTION**

DESIGN CONTRACTS AND DELIVERY  
DYLUNIO CONTRACTAU A DARPARU

**Andrew Gregory**  
DIRECTOR FOR PLANNING, TRANSPORT AND ENVIRONMENT  
CYNNLUNIO, TRAFNIDIATH A'R AMGYLCHEDD

Rev	By	Date	Description of Amendment	Chk.by	Date

Project	PRIORITY NARROWING IMPROVEMENTS		
Checked	GC	Path	
Scale	AS SHOWN	Project Number	CO19047
Date	08/19	Drawing Number	003
Title ROMILLY ROAD			
<small>Do not scale drawing except for planning application purposes.</small> County Hall, Atlantic Wharf, Cardiff CF10 4UW Telephone 029 2287 2456			