

KEY

BOUNDARY TYPES

Note: Existing boundary treatments to be retained where suitable and replaced where necessary.

- - - Site boundary.
- - - 2100mm metal railings.
- - - 1200mm high post and rail fence / ballustrade
- - - 1800mm close boarded fencing.
- - - 2100mm close boarded fencing.
- - - 1800mm close boarded fencing on top of brick retaining wall.
- - - 1100mm high close boarded fencing.
- - - Max 600mm high brickwork retaining wall

SYMBOLS

- 1 Plot numbers.
- K Dwelling Types.
- S/P Car parking space allocation.
- Garden shed.
- 1 in 2 rollover.
- Rotary dryer.
- Existing combined drain with 3m easement each side.
- Proposed trees.

LANDSCAPING MATERIALS

- Flag Paving - Light.
- A/B Tarmac footpath / road.
- c Grassed area.
- Low maintenance planting.

Revisions

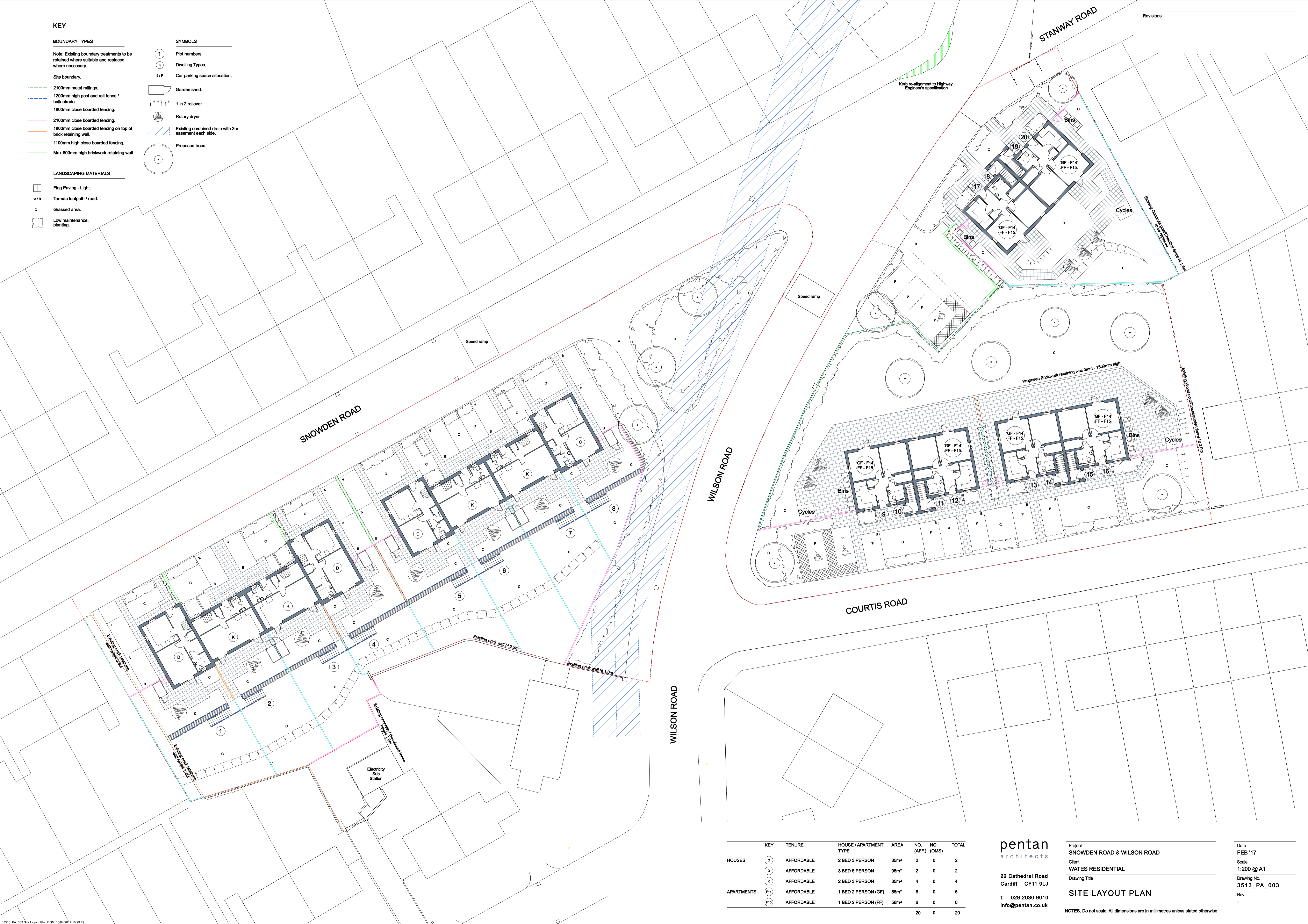

KEY	TENURE	HOUSE / APARTMENT TYPE	AREA	NO. (AFF.)	NO. (OMS)	TOTAL
C	AFFORDABLE	2 BED 3 PERSON	85m ²	2	0	2
D	AFFORDABLE	3 BED 5 PERSON	95m ²	2	0	2
K	AFFORDABLE	2 BED 3 PERSON	85m ²	4	0	4
F14	AFFORDABLE	1 BED 2 PERSON (GF)	58m ²	6	0	6
F15	AFFORDABLE	1 BED 2 PERSON (FF)	58m ²	6	0	6
				20	0	20

pentan
architects

22 Cathedral Road
Cardiff CF11 9LJ
t: 029 2030 9010
info@pentan.co.uk

Project
SNOWDEN ROAD & WILSON ROAD

Client
WATES RESIDENTIAL

Drawing Title
SITE LAYOUT PLAN

NOTES: Do not scale. All dimensions are in millimetres unless stated otherwise

Date
FEB '17

Scale
1:200 @ A1

Drawing No.
3513_PA_003

Rev.
-